

KOYAMBEDU

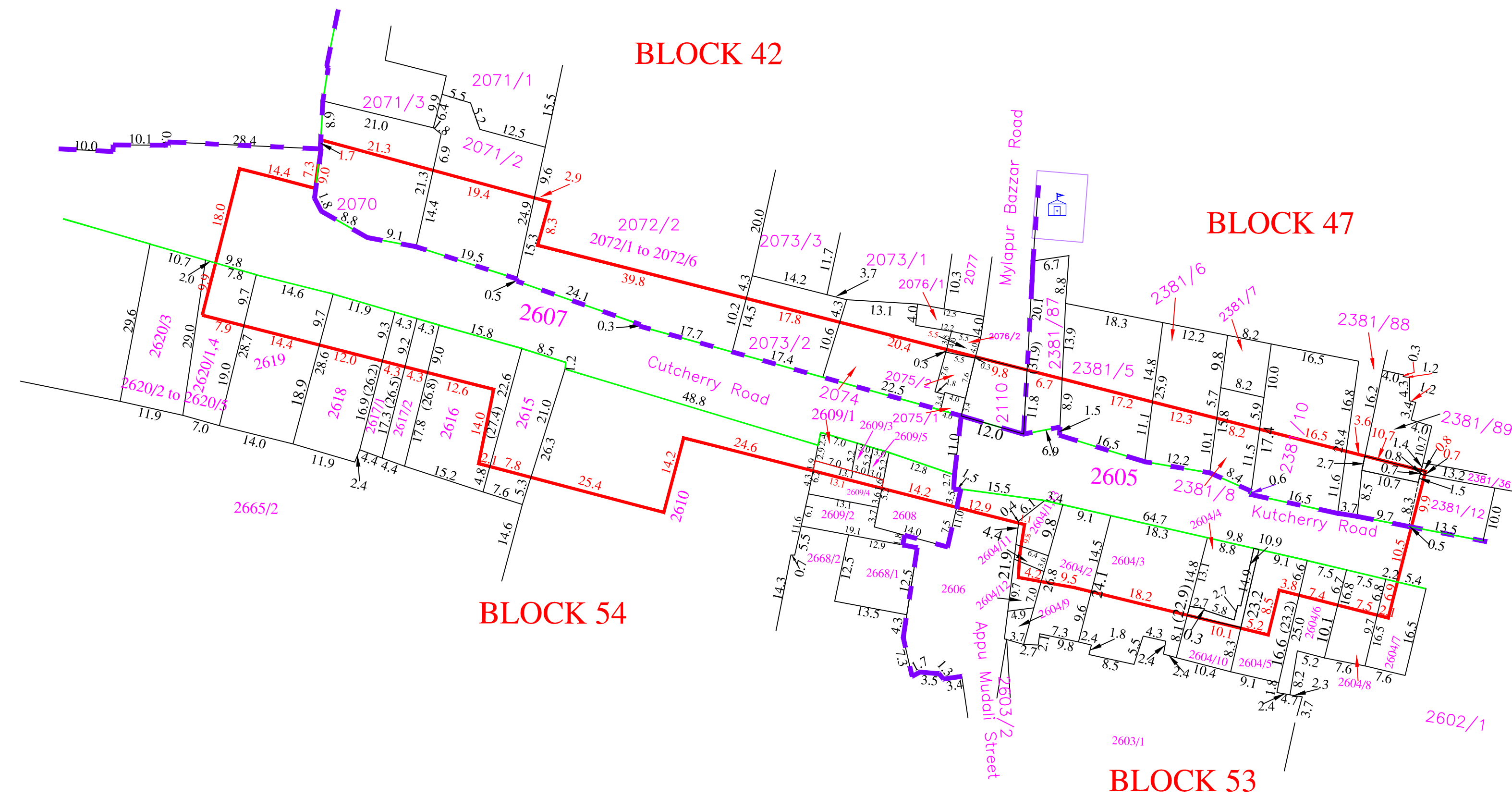

STATION NO.03.KUTCHERY ROAD (Village-Mylapore)

LIGHT HOUSE

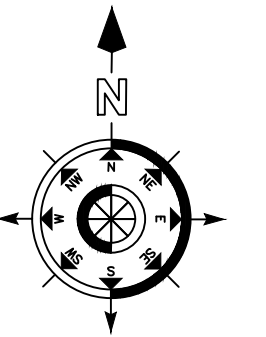

LEGEND

- PROPOSED CMRL STATION BOUNDARY —
- BLOCK BOUNDARY - - -
- FIELD BOUNDARY —
- ROAD AND STREET BOUNDARY —

CLIENT :
CHENNAI METRO RAIL LIMITED
Admin Building, CMRL Depot,
Poonamillee High Road,
Koyambedu, Chennai - 600 107.
Ph: 044-23792000 , Fax: 044-23792200.
Email- chennaiemtorail@gmail.com

SURVEY CONSULTANT :
Prime Meridian Surveys Private Limited.,
New No. 68/6,(Old No. 63/6),
Madhangai Apartment, Jones Road,
Sholinganallur, Chennai - 600 015.
Ph: 044-23813668 , Fax: 044-23813669.
Email- meridiansurveys@gmail.com

GENERAL NOTES :
1. ALL DIMENSIONS ARE IN METER. UNLESS OTHERWISE NOTED.

REV.	DATE	DESCRIPTION

CGM (UG) - CMRL

DESIGNED/DRAWN:

CHECKED :
G.Siva

CHENNAI METRO RAIL PROJECT PHASE - II			
TITLE :	03.KUTCHERY ROAD	SHEET NO	SHEET SIZE
DRAWING NAME:	LAND PLAN SCHEDULE	1 of 1	A1
DRAWING NUMBER:	PMSPL/CMRL PII/COR 4/STN/LPS/03	SCALE:	1 : 1000
		DRAWN DATE:	26 - 10 - 2018