

POONAMALLE BYPASS

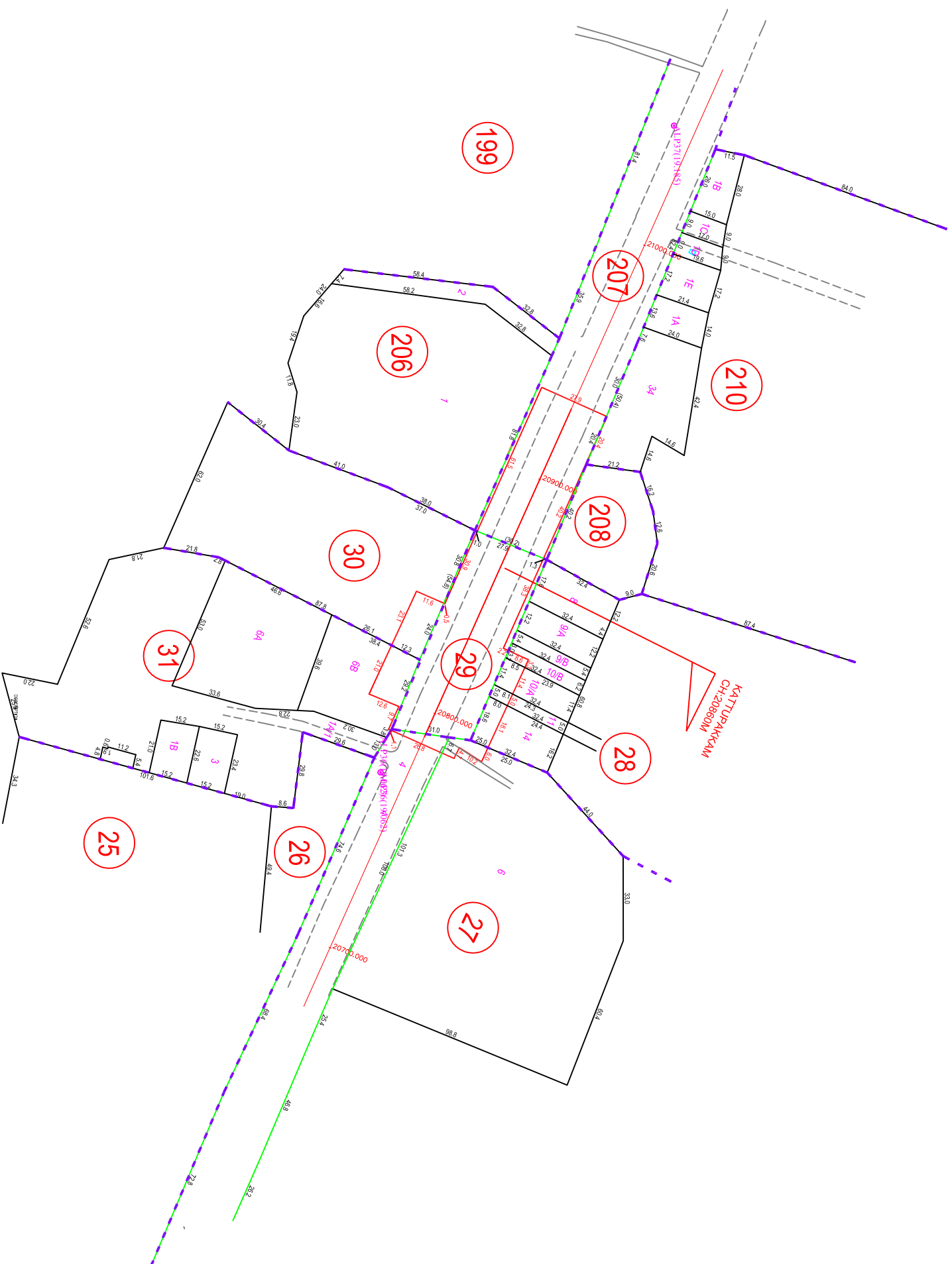

THIRUVALLUR DISTRICT  
POONAMALLE TALUK  
CORRIDOR NO.4- 25, KATTUPPAKKAM  
AT CHAINAGE 20860.0m

LIGHT HOUSE

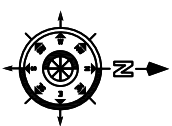

**LEGEND:-**

- PROPOSED CMRL STATION BOUNDARY
- BLOCK BOUNDARY
- FIELD BOUNDARY
- ROAD AND STREET BOUNDARY

CLIENT : **CHENNAI METRO RAIL LIMITED**  
 Admin Building, CMRL Depot,  
 Poonamalle High Road,  
 Koyambettu, Chennai - 600 107  
 Ph: 044-23792200, Fax: 044-23792200,  
 Email: chennai@metro@gmail.com

SURVEY CONSULTANT : **Prime Meridian Surveys Private Limited.,**  
 New No. 686, Old No. 63/6,  
 Madhav Apartment, Jones Road,  
 Shilpesh, Chennai - 600 015  
 Ph: 044-2313988, Fax: 044-2313988,  
 Email: meridiansurveys@gmail.com

GENERAL NOTES:  
 1. ALL DIMENSIONS ARE IN METER, UNLESS OTHERWISE NOTED.

<p>DRW. CMRL</p>		<p>DRAWN: R.P.S</p>		<p><b>CHENNAI METRO RAIL PROJECT PHASE - II</b></p>	
<p>REV. DATE</p>		<p>CHECKED: G.N.K</p>		<p>TITLE : 24.IVYAPPANTHANGAL BUS DEPOT</p>	
<p>DESCRIPTION</p>		<p>DRAWING NAME: LAND PLAN SCHEDULE</p>		<p>SHEET NO. SHEET SIZE 1 of 1 A1</p>	
<p>DRW. CMRL</p>		<p>DRAWING NUMBER: PMSPL/CMRL/PI/COOR 4/LPS/COM/25</p>		<p>SCALE: 1 : 1000</p>	
<p>DRW. CMRL</p>		<p>DATE:</p>		<p>DRWING DATE: 22-02-2019</p>	