

STATION No.06.MMBT VILLAGE - MADHAVARAM

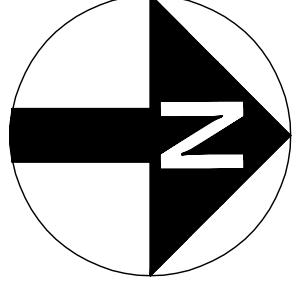

MADHAVARAM



SHOLINGANALLUR

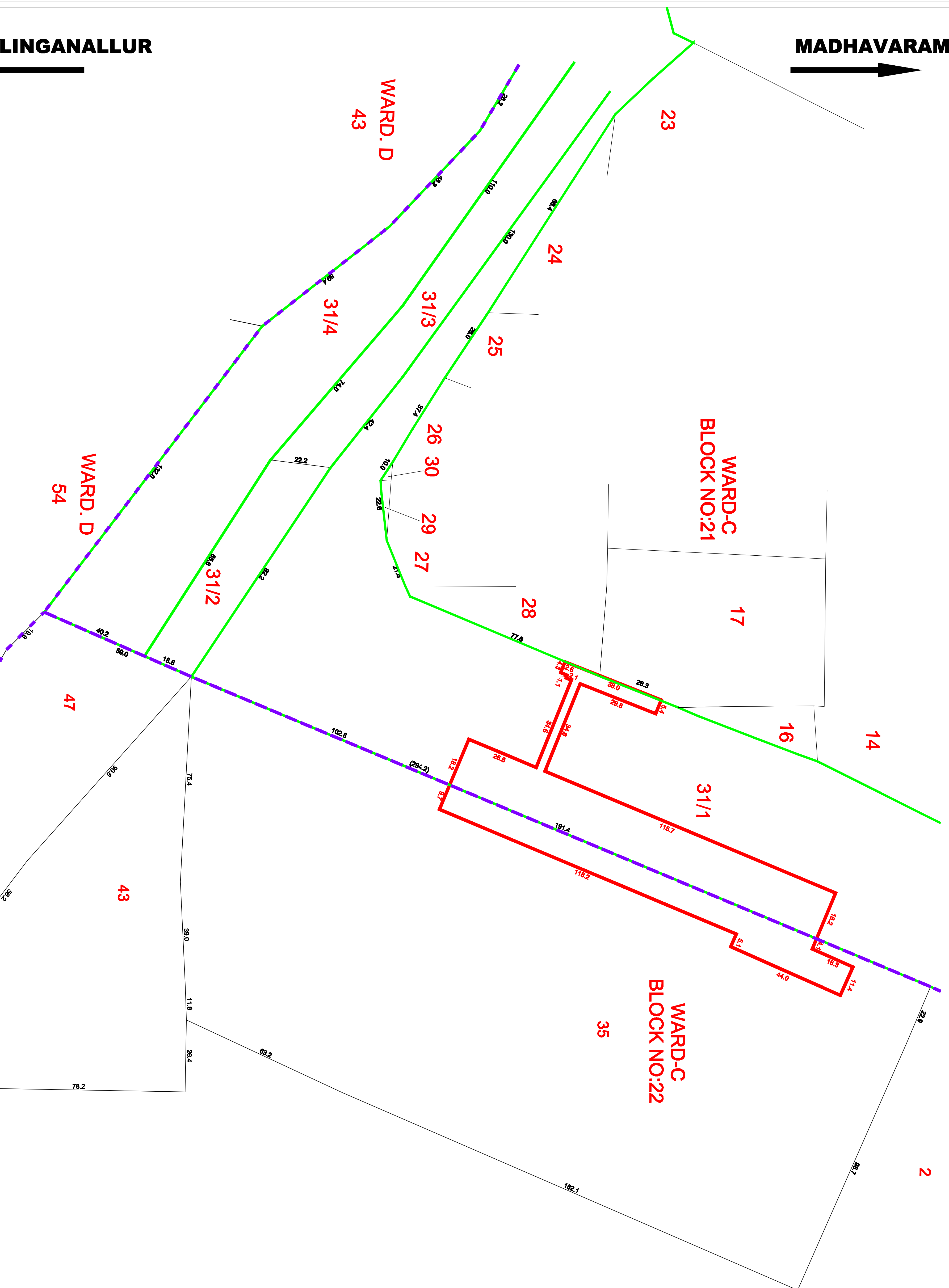

LEGEND	
—	PROPOSED CMRL STATION BOUNDARY
- - -	BLOCK BOUNDARY
—	FIELD BOUNDARY
—	ROAD BOUNDARY

CHENNAI METRO RAIL LIMITED
 Admin Building, CMRL Depot,
 Poornamesa High Road,
 Koyambedu, Chennai - 600 107,
 Ph: 044-23792000, Fax: 044-23792200,
 Email: chennai@metrorail.com

PRIME CONSULTANT:
Prime Meridian Surveys Private Limited,
 New No. 69/6 (Old No. 63/6),
 Madhavangal Apartment, Jones Road,
 Saidapet, Chennai - 600 015,
 Ph: 044-23813988, Fax: 044-23813989,
 Email: prime@meridiansurveys.com

GENERAL NOTES:
 1. ALL DIMENSIONS ARE IN METERS UNLESS OTHERWISE NOTED.

REV.	DATE	DESCRIPTION

DESIGNED/DRAWN:	CHECKED:
G.SIVA	G.SIVA

CGM (UG) - CMRL

CHENNAI METRO RAIL PROJECT PHASE - II	
TITLE:	MMBT
DRAWING NAME:	LAND PLAN SCHEDULE
DRAWING NUMBER:	PM/SPL/CMRL PII/COR 5/STN/LPS/6
SHEET NO:	1 of 1
SHEET SIZE:	A1
SCALE:	1:1000
DRAWN DATE:	29-06-2018