

MADHAVARAM



SHOLINGANALLUR



STATION No.07. SHASTRI NAGAR VILLAGE NAME - MADHAVARAM

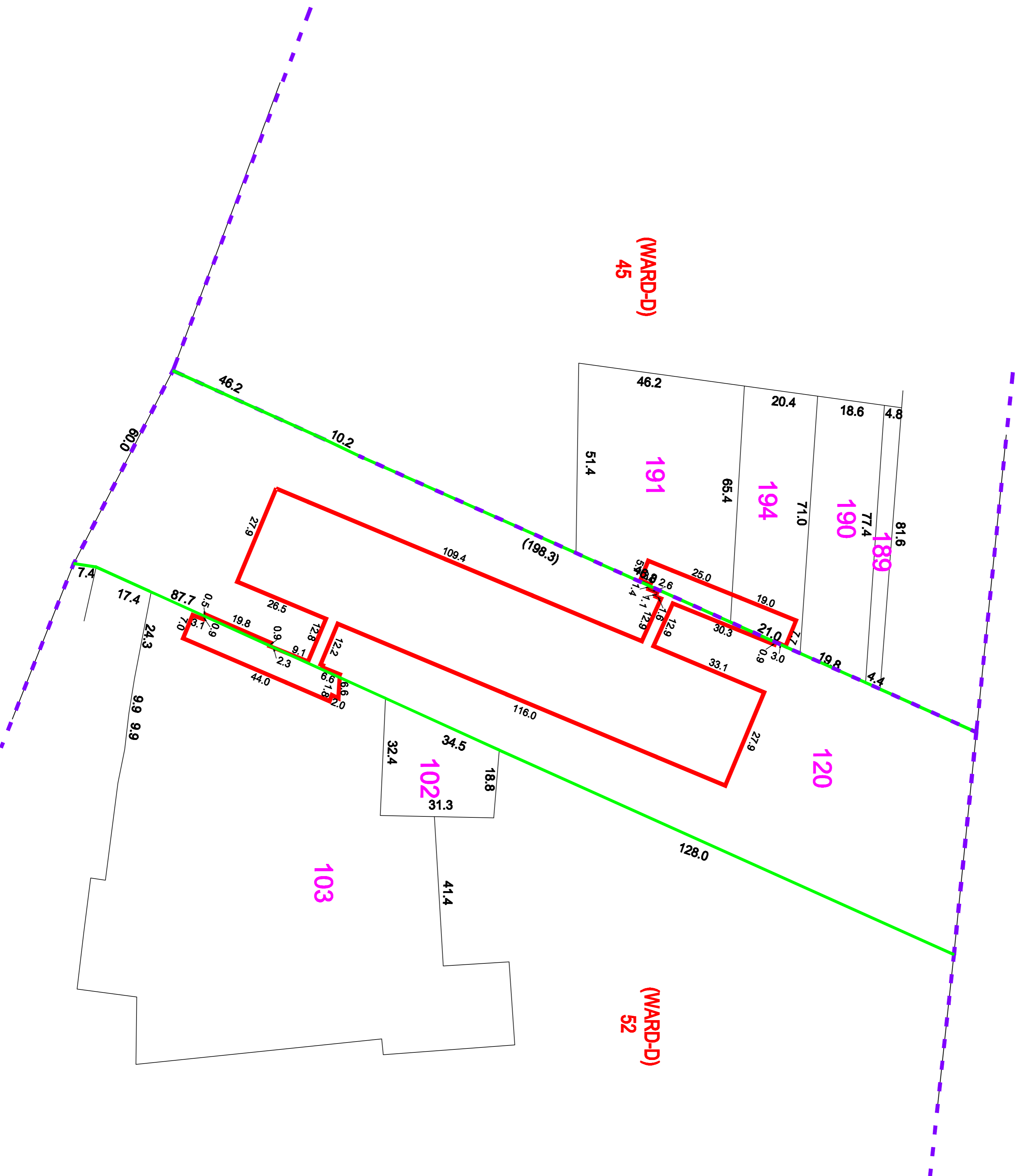
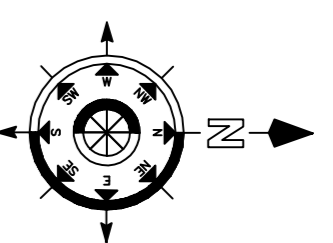

LEGEND

- PROPOSED CMRL STATION BOUNDARY
- - - BLOCK BOUNDARY
- FIELD BOUNDARY
- ROAD BOUNDARY

CLIENT :
CHENNAI METRO RAIL LIMITED
 Admin Building, CMRL Depot,
 Poornambai High Road,
 Koyambedu, Chennai - 600 107,
 Ph: 044-23792000, Fax: 044-23792200,
 Email: chennaiMetroRail@gmail.com

SURVEY CONSULTANT:

Prime Meridian Surveys Private Limited.
 New No. 68/6, Old No. 63/6,
 Meenambal Apartment, Jones Road,
 Saidapet, Chennai - 600 015,
 Ph: 044-23813868, Fax: 044-23813869,
 Email: meridianSurveys@gmail.com

GENERAL NOTES :
 1. ALL DIMENSIONS ARE IN METERS UNLESS OTHERWISE NOTED.
 This drawing is the property of Chennai Metro Rail Limited and shall be handed to any person or firm for use restricted to the project and shall not be copied or otherwise made available in full or in part by any means to any other person or firm without the written consent of Chennai Metro Rail Limited.

REV: DATE

DESCRIPTION

CGM (UG) - CMRL

DESIGNED/DRAWN:
 CHECKED:
G Siva

CHENNAI METRO RAIL PROJECT PHASE - II
 TITLE : SHASTRI NAGAR
 DRAWING NAME: LAND PLAN SCHEDULE
 DRAWING NUMBER: PMS/PL/CMRL PI/COR 5/STN/LPS/07
 SHEET NO: 1 of 1
 SHEET SIZE: A1
 SCALE: 1 : 500
 DRAWING DATE: 28-06-2019